

MOLA

AÇO INOX AISI 302
 AÇO INOX AISI 304
 AÇO INOX AISI 316
 INCONEL X-750

VEDAÇÃO

EPDM
 BUNA-N
 VITON
 NEOPRENE
 SILICONE
 HYPALON
 SBR
 PTFE
 METAL/METAL

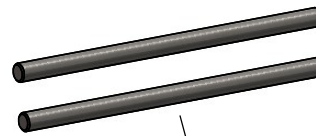

EIXO

AÇO INOX AISI 410
 AÇO INOX AISI 304
 AÇO INOX AISI 316

**BUCHA
NYLON**

PLUG
AÇO GALVANIZADO

CORPO e PORTINHOLA

FERRO FUNDIDO CINZENTO ASTM A126
 FºFº NODULAR ASTM A536 GR. 65.45.12
 BRONZE INDUSTRIAL B62
 BRONZE ALUMÍNIO ASTM B148
 AÇO CARBONO ASTM A216 GR. WCB
 AÇO INOX ASTM A351 GR. CF8
 AÇO INOX ASTM A351 GR. CF8M

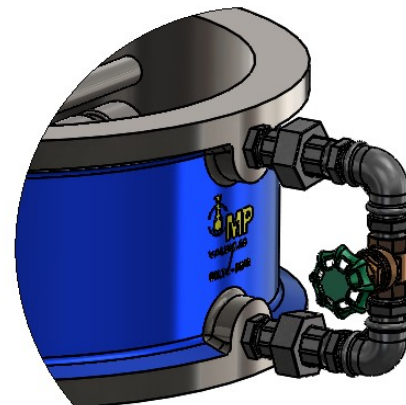

OPCIONAL SISTEMA BY-PASS
PARA VÁLVULAS DN.12" Á DN.46"

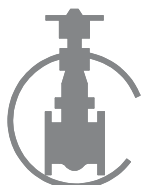

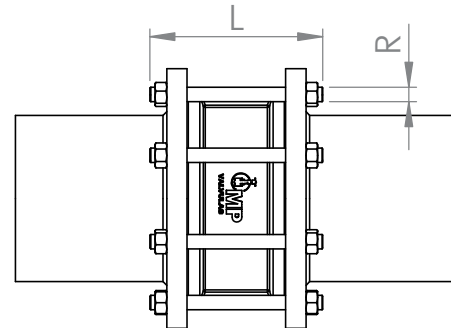
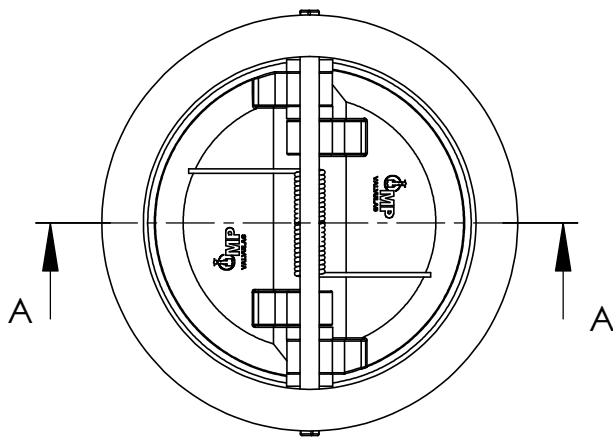
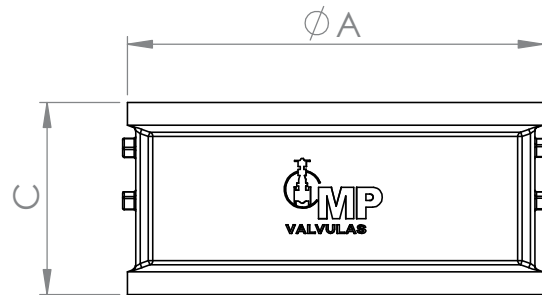
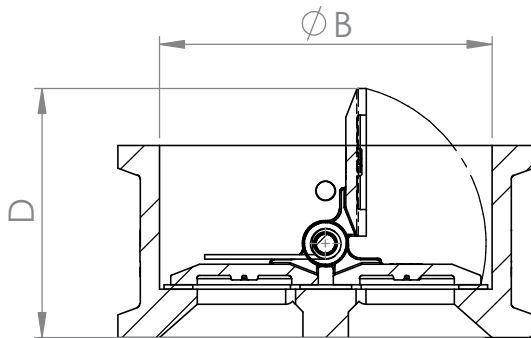

CARACTERÍSTICAS:

NORMA DE CONSTRUÇÃO CONFORME
API 594, ASME B16.5, DIN PN10/16

NORMA DE TESTE CONFORME API 598
OBS. VEDAÇÃO METAL X METAL -
O teste de vedação não atende a Norma
API 598 - Classe de vedação IV

| DN | A | B | C | D | N | R (inch) | L PRIS. |
|------|------|------|-----|-----|----|-------------|------------|
| 1.½" | 82 | 55 | 60 | 52 | 4 | W 1/2" | 130 |
| 2" | 106 | 68 | 60 | 55 | 4 | W 5/8" | 145 |
| 2.½" | 121 | 79 | 67 | 65 | 4 | W 5/8" | 157 |
| 3" | 135 | 88 | 73 | 73 | 4 | W 5/8" | 163 |
| 4" | 170 | 119 | 73 | 90 | 8 | W 5/8" | 163 |
| 5" | 192 | 140 | 86 | 105 | 8 | W 3/4" | 181 |
| 6" | 220 | 169 | 98 | 126 | 8 | W 3/4" | 198 |
| 8" | 275 | 220 | 127 | 170 | 8 | W 3/4" | 237 |
| 10" | 330 | 272 | 146 | 205 | 12 | W 7/8" | 261 |
| 12" | 405 | 324 | 181 | 245 | 12 | W 7/8" | 301 |
| 14" | 440 | 366 | 184 | 275 | 12 | W 1" | 319 |
| 16" | 490 | 416 | 191 | 315 | 16 | W 1" | 325 |
| 18" | 540 | 466 | 203 | 340 | 16 | W 1.½" | 348 |
| 20" | 595 | 511 | 219 | 370 | 20 | W 1.½" | 379 |
| 24" | 714 | 616 | 222 | 415 | 20 | W 1.¼" | 392 |
| 26" | 770 | 660 | 305 | 455 | 24 | W 1.¼" | 525 |
| 28" | 828 | 700 | 305 | 480 | 28 | W 1.¼" | 525 |
| 30" | 878 | 764 | 305 | 510 | 28 | W 1.¼" | 532 |
| 32" | 934 | 820 | 326 | 550 | 28 | W 1.½" | 580 |
| 36" | 1040 | 900 | 368 | 610 | 32 | W 1.½" | 640 |
| 40" | 1160 | 1000 | 432 | 670 | 36 | W 1.½" | 705 |
| 42" | 1216 | 1050 | 432 | 700 | 36 | W 1.½" | 720 |
| 46" | 1324 | 1170 | 524 | 803 | 40 | W 1.½" | 815 |

