

DN. 50 a 350

1	CORPO	FERRO NODULAR ASTM A536
2	CONTRA SEDE	FERRO NODULAR ASTM A536
3	ANEL DO CORPO	FERRO NODULAR ASTM A536
4	ANEL DA CONTRA SEDE	BORRACHA BUNA-N
5	CRIVO	AÇO 1020*
6	PARAFUSOS	A 307 GR.A

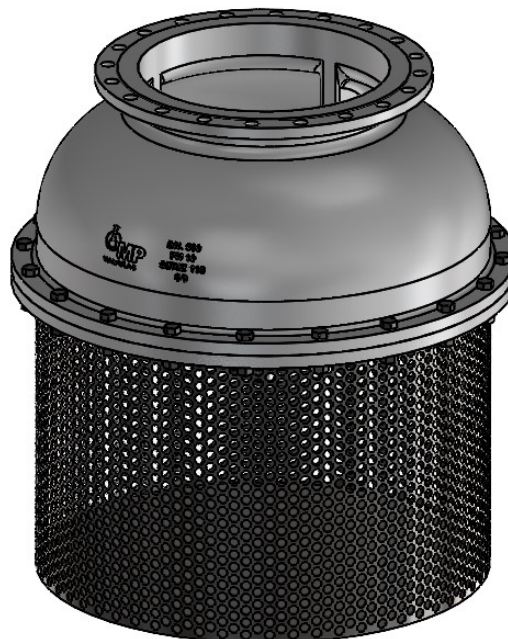

DN. 400 a 600

Obs. * Opção de crivo em aço inox (sob consulta)

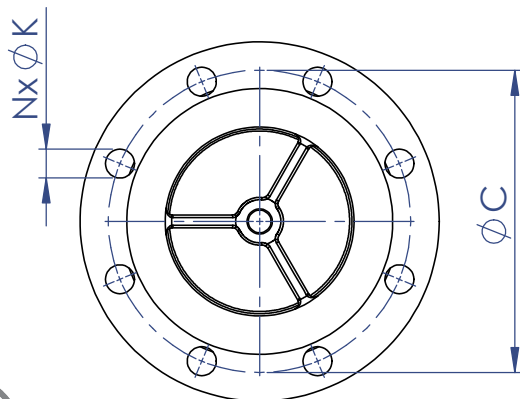
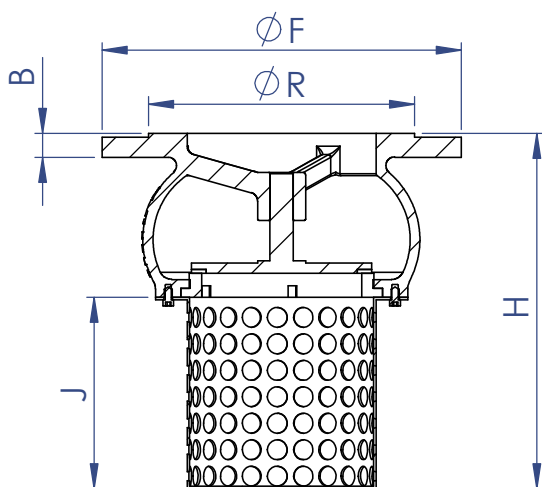

	DN	F	R	B	C	N	K	H	J
PN 16	50	165	99	19	125	4	19	180	100
	65	185	122	19	145	4	19	200	110
	75	194	127	19	154	4	19	220	130
	80	200	132	19	160	8	19	220	130
	100	220	156	19	180	8	19	250	150
	125	250	188	19	210	8	19	280	150
	150	285	211	19	240	8	23	280	150
PN 10	200	340	266	20	295	12	23	380	200
	200	340	266	20	295	8	23	380	200
	250	400	319	22	350	12	23	450	250
	300	455	370	24,5	400	12	23	550	300
	350	505	429	24,5	460	16	23	590	350
	400	565	480	24,5	515	16	28	700	400
	450	615	530	25,5	565	20	28	830	450
	500	670	582	26,5	620	20	28	950	500
	600	780	682	30	725	20	31	1050	600

